

# CROLL S / CROLL L

CE 0082

EAC TPTC019/2011

NFPA

UIAA

Ventral rope clamp  
Bloqueur ventral

	CROLL S	CROLL L
EN 567: 2013	8 ≤ Ø ≤ 11 mm	8 ≤ Ø ≤ 13 mm
EN 12841: 2006	10 ≤ Ø ≤ 11 mm	10 ≤ Ø ≤ 13 mm

EN 1891  
EN 892

## WARNING / ATTENTION

Activities involving the use of this equipment are inherently dangerous. You are responsible for your own actions and decisions.

Before using this equipment, you must:

- Read and understand all Instructions for Use.
- Get specific training in its proper use.
- Become acquainted with its capabilities and limitations.
- Understand and accept the risks involved.



Les activités impliquant l'utilisation de cet équipement sont par nature dangereuses. Vous êtes responsable de vos actes, de vos décisions et de votre sécurité.

Avant d'utiliser cet équipement, vous devez :

- Lire et comprendre toutes les instructions d'utilisation.
- Vous former spécifiquement à l'utilisation de cet équipement.
- Vous familiariser avec votre équipement, apprendre à connaître ses performances et ses limites.
- Comprendre et accepter les risques induits.

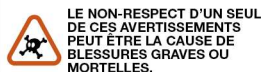

PETZL.COM

Latest version  
Dernière version

Other languages  
Autres langues

Technical tips  
Conseils techniques

PPE checking  
Fiche de contrôle EPI

Warning symbols  
Panneaux d'alertes

PETZL  
F-38920 Crolles  
Cidex 105A  
PETZL.COM  
ISO 9001 © Petzl

Sustaining our Community  
Au service de la Communauté  
FONDATION-PETZL.ORG

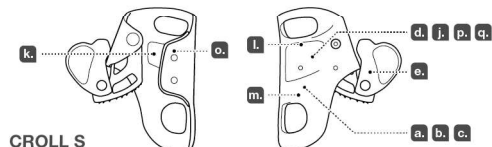
Traceability and markings /  
Traçabilité et marquage

CROLL S

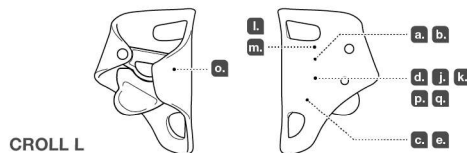

CROLL L

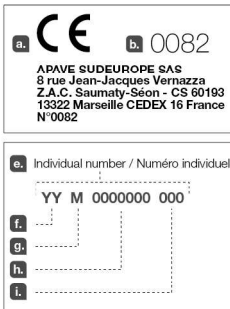

## NFPA CERTIFICATION FOR CERTIFICATION NFPA POUR CROLL S AND CROLL L

MEETS ASCENDER REQUIREMENTS OF  
CONFORME AUX EXIGENCES POUR  
POIGNEE-BLOQUEUR DE

NFPA 1983, STANDARD ON LIFE SAFETY ROPE AND  
EQUIPMENT FOR EMERGENCY SERVICES,  
2017 EDITION.

EMERGENCY SERVICES  
ASCENDING DEVICE  
IN ACCORDANCE  
WITH NFPA 1983-2017  
T (TECHNICAL USE)

Use only TECHNICAL or GENERAL USE LIFE SAFETY  
ROPES, (core + sheath) diameter between 10 mm and 11 mm.

This CROLL S has passed the manner of function test using the  
following rope: [STERLING HTP static P105, 3/8", 10mm]  
and [PETZL AXIS, 11mm]

Use only TECHNICAL or GENERAL USE LIFE SAFETY  
ROPES, (core + sheath) diameter between 10 mm and 13 mm.

This CROLL L has passed the manner of function test using the  
following rope: [STERLING HTP static P105, 3/8", 10mm] and  
[TEUFELBERGER FIBER ROPE KMIII 1/2", 13mm]

Utilisez uniquement des TECHNICAL ou GENERAL USE LIFE  
SAFETY ROPES, de diamètre (âme + gaine) compris entre  
10 mm et 11 mm.

Ce CROLL S a passé les tests de fonctionnement avec les cordes  
suivantes : STERLING HTP static P105, 3/8", 10mm]  
et [PETZL AXIS, 11mm]

Utilisez uniquement des TECHNICAL ou GENERAL USE LIFE  
SAFETY ROPES, de diamètre (âme + gaine) compris entre  
10 mm et 13 mm.

Ce CROLL L a passé les tests de fonctionnement avec les cordes  
suivantes : [STERLING HTP static P105, 3/8", 10mm] et  
[TEUFELBERGER FIBER ROPE KMIII 1/2", 13mm]

After removing the notice from the equipment, make a copy of it and keep the  
original as part of a permanent record that includes the usage and inspection  
history for the equipment. Keep the copy of the notice with the equipment and  
refer to it before and after each use. Additional information regarding auxiliary  
equipment can be found in NFPA 1500, Standard on Fire Department  
Occupational Safety and Health Program, and NFPA 1983, Standard on Fire  
Service Life Safety Rope and System Components.

Après avoir détaché la notice du produit, faites en une copie et gardez l'original  
dans un dossier qui compile l'historique de vie du produit et les vérifications EPI  
réalisées. Gardez une copie de la notice avec le produit et consultez-la avant et  
après chaque utilisation. Des informations complémentaires sont disponibles  
dans les normes : NFPA1500, Standard on Fire Department Occupational  
Safety and Health Program, and NFPA 1983, Standard on Fire Service Life  
Safety Rope and System Components.

1. Field of application (text part)  
Champ d'application (partie texte)

2. Nomenclature

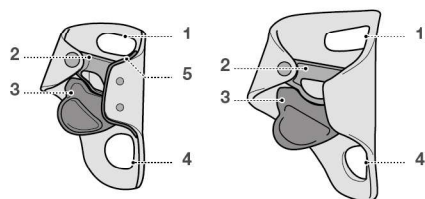

CROLL S

CROLL L

3. Inspection, points to verify  
Contrôle, points à vérifier



4. Compatibility (text part)  
Compatibilité (partie texte)

5. Function principle and test  
Principe et test de fonctionnement

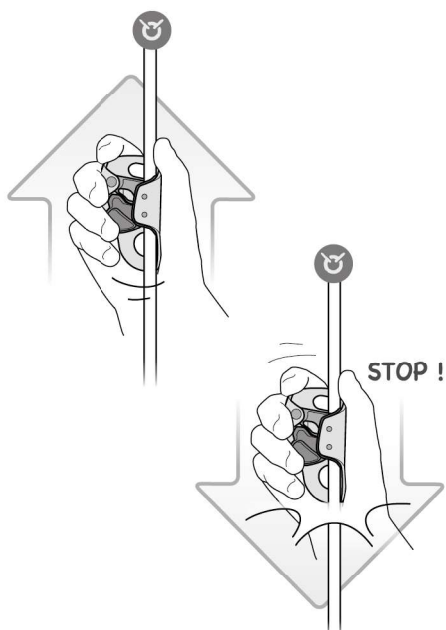

6. Installation on the harness  
Installation sur le harnais

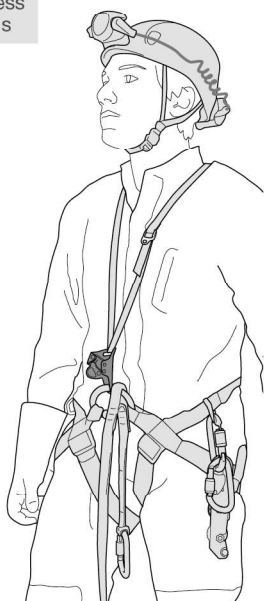
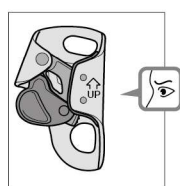
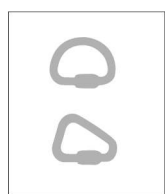

7. Installing and removing the rope  
Mise en place et retrait de la corde

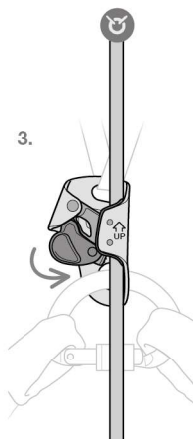
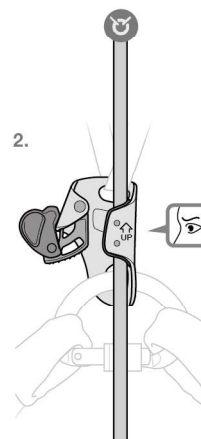
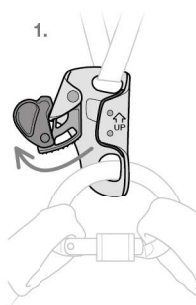

## 8. Rope ascent Remontée sur corde

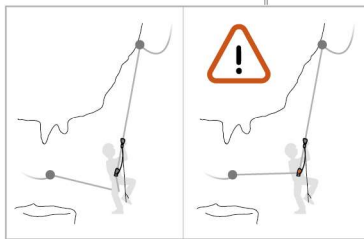
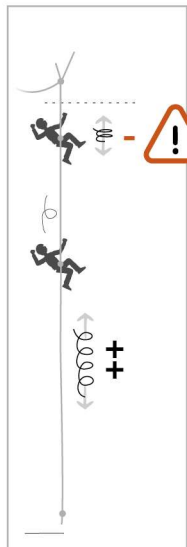

## 9. Short rope descent Courte descente

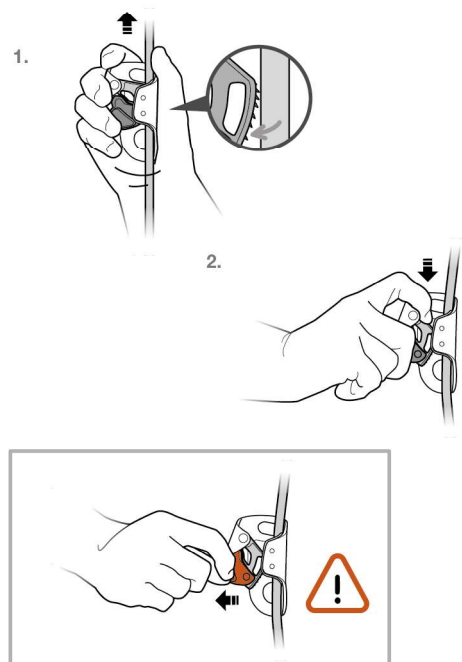

## 10. EN 12841 EN 12841



## Precautions for use Précautions d'utilisation

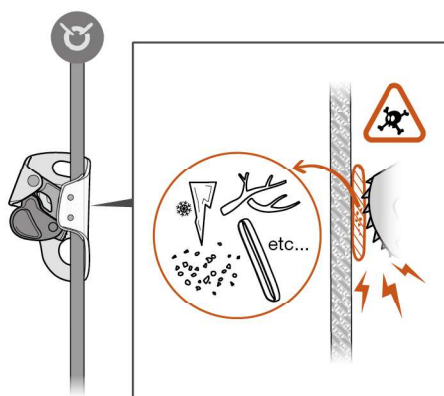

## Accessories Accessoires

**SECUR** C74  
**TORSE** C26

## 11. Additional information Informations complémentaires

### A. Lifetime / Durée de vie

∞ unlimited  
illimitée

### B. Acceptable T° T° tolérées

+ 80°C / + 176°F  
- 40°C / - 40°F

### C. Precautions for use / Précautions d'usage



### D. Cleaning / Nettoyage

+ 30°C maxi.  
+ 86°F maxi.



### E. Drying / Séchage

+ 30°C maxi.  
+ 86°F maxi.



### F. Storage - Transport Stockage - transport

+ 30°C / + 86°F  
+ 10°C / + 50°F



### G. Maintenance Entretien



### H. Modifications - Repairs Modifications - Réparations



### I. FAQ - Contact Questions - Contact



→ Petzl

→ petzl.com



These instructions explain how to correctly use your equipment. Only certain techniques and uses are described.

The warning symbols inform you of some potential dangers related to the use of your equipment, but it is impossible to describe them all. Check Petzl.com for updates and additional information.

You are responsible for heeding each warning and using your equipment correctly. Any misuse of this equipment will create additional dangers. Contact Petzl if you have any doubts or difficulty understanding these instructions.

## 1. Field of application

Personal protective equipment (PPE) used for fall protection.

Ventral rope clamp for ascending rope.

- Rope clamp for mountaineering and climbing (EN 567).

- Ascending device for the work rope (EN 12841: 2006 type B).

This product must not be pushed beyond its limits, nor be used for any purpose other than that for which it is designed.

## Responsibility

### WARNING

**Activities involving the use of this equipment are inherently dangerous. You are responsible for your own actions, decisions and safety.**

Before using this equipment, you must:

- Read and understand all Instructions for Use.

- Get specific training in its proper use.

- Become acquainted with its capabilities and limitations.

- Understand and accept the risks involved.

**Failure to heed any of these warnings may result in severe injury or death.**

This product must only be used by competent and responsible persons, or those placed under the direct and visual control of a competent and responsible person. You are responsible for your actions, your decisions and your safety and you assume the consequences of same. If you are not able, or not in a position to assume this responsibility, or if you do not fully understand the Instructions for Use, do not use this equipment.

## 2. Nomenclature

(1) Chest strap attachment hole, (2) Cam, (3) Safety catch, (4) Harness attachment hole, (5) Wear plate (CROLL S only).

Principal materials: aluminum alloy frame, stainless steel cam and wear plate.

## 3. Inspection, points to verify

Your safety is related to the integrity of your equipment.

Petzl recommends a detailed inspection by a competent person at least once every 12 months (depending on current regulations in your country, and your conditions of usage). Record the results on your PPE inspection form: type, model, manufacturer contact info, serial number or individual number, dates: manufacture, purchase, first use, next periodic inspection; problems, comments, inspector's name and signature.

### Before each use

On the product, verify the absence of any cracks, deformation, marks, wear, corrosion...

Check the condition of the frame, the attachment holes, the cam and safety catch, the springs and the cam axle.

Check the mobility of the cam and the effectiveness of its spring.

Check that the teeth are not fouled.

WARNING: do not use this rope clamp if it has missing or worn-out teeth.

### During use

It is important to regularly monitor the condition of the product and its connections to the other equipment in the system. Make sure that all items of equipment are correctly positioned with respect to each other.

BEWARE:

- of foreign objects that can impede the operation of the cam,

- of situations where the safety catch can snag and cause the cam to open.

## 4. Compatibility

Verify that this product is compatible with the other elements of the system in your application (compatible = good functional interaction).

Equipment used with your CROLL must meet current standards in your country (e.g. EN 12275 carabiners).

### Connectors

Verify connector/rope clamp compatibility (installation, correct functioning and assessment of the potential for poor positioning).

## 5. Function principle and test

It slides along the rope in one direction and locks in the other direction.

The cam's teeth initiate a clamping action that locks the rope by pinching it between the cam and the frame. The slot in the cam allows mud to be evacuated.

## 6. Installation on the harness

Attach the device to the harness by passing a quick link or an OMNI through the connection hole.

Connect the chest strap to the upper hole, so that the device is held in a vertical position against the chest.

The CROLL is only to be used when it is connected directly to the harness, without a lanyard.

Close the CROLL's cam when not in use, as equipment or other objects can jam in the rope channel if left open.

## 7. Installing and removing the rope

Observe the Up/Down indicator.

### To remove the rope

Move the device up the rope while opening the safety catch to disengage the cam.

## 8. Ascending the rope

Use the CROLL with another rope clamp (e.g. BASIC) and a foot loop. Always attach yourself to the second rope clamp with an appropriate lanyard.

### Angled traverse situation

Starting on an angled rope: put a leg over the rope to align it with the CROLL's rope channel.

## 9. Short descent

Slide the device slightly up the rope and simultaneously push the cam with your index finger. Do not manipulate the safety catch because there is a risk of accidentally opening the cam.

## 10. EN 12841 type B - additional information

**The CROLL must be used with a type A backup device on a second (safety) rope.**

- The CROLL is not suitable for use in a fall arrest system.

- To meet the requirements of the EN 12841: 2006 type B standard, use 891 type A low stretch kernmantel ropes: 10-11 mm diameter with CROLL S and 10-13 mm with CROLL L.

(Note: certification testing was performed using Petzl CLUB 10 mm, Petzl AXIS 11 mm and Teufelberger KM3 13 mm ropes.)

- Use a connector that has a maximum total length of 15 cm (connector that attaches the CROLL to the harness attachment point).

- Do not allow slack in the rope between the rope adjustment device and the anchor, in order to reduce the risk of a fall.

When your body weight is on the work rope, make sure that the safety rope is not loaded.

A dynamic overload can damage the safety rope.

Nominal maximum load: 140 kg.

## 11. Additional information

This product meets the requirements of Regulation (EU) 2016/425 on personal protective equipment. The EU declaration of conformity is available at Petzl.com.

- You must have a rescue plan and the means to rapidly implement it in case of difficulties encountered while using this equipment.

- The anchor point for the system should preferably be located above the user's position and should meet the requirements of the EN 795 standard (12 kN minimum strength).

- In a fall arrest system, it is essential to check the required clearance below the user before each use, in order to avoid hitting the ground or an obstacle in case of a fall.

- Make sure that the anchor point is correctly positioned, in order to limit the risk and the length of a fall.

- A fall arrest harness is the only device allowable for supporting the body in a fall arrest system.

- When using multiple items of equipment, a dangerous situation can arise in which the safety function of an item of equipment can be affected by the safety function of another item of equipment.

- WARNING - DANGER: take care that your products do not rub against abrasive or sharp surfaces.

- Users must be medically fit for activities at height. WARNING: inert suspension in a harness can result in serious injury or death.

- The Instructions for Use for each item of equipment used in conjunction with this product must be followed.

- The Instructions for Use must be provided to the user of this equipment, in the language of the country where the equipment is used.

- Make sure the markings on the product are legible.

### When to retire your equipment:

WARNING: an exceptional event can lead you to retire a product after only one use, depending on the type and intensity of usage and the environment of usage (harsh environments, marine environments, sharp edges, extreme temperatures, chemicals...).

A product must be retired when:

- It has been subjected to a major fall (or load).

- It fails to pass inspection. You have any doubt as to its reliability.

- You do not know its full usage history.

- When it becomes obsolete due to changes in legislation, standards, technique or incompatibility with other equipment...

Destroy these products to prevent further use.

### Icons:

**A. Unlimited lifetime - B. Acceptable temperatures - C. Usage precautions - D. Cleaning - E. Drying - F. Storage/transport - G. Maintenance - H.**

**Modifications/repairs** (prohibited outside of Petzl facilities, except replacement parts) - **I. Questions/contact**

## 3-year guarantee

Against any material or manufacturing defect. Exclusions: normal wear and tear, oxidation, modifications or alterations, incorrect storage, poor maintenance, negligence, uses for which this product is not designed.

## Warning symbols

1. Situation presenting an imminent risk of serious injury or death. 2. Exposure to a potential risk of accident or injury. 3. Important information on the functioning or performance of your product. 4. Equipment incompatibility.

## Traceability and markings

a. Meets PPE regulatory requirements. Notified body performing the EU type examination - b. Number of the notified body responsible for the production control of this PPE - c. Traceability: datamatrix - d. Diameter - e. Serial number - f. Year of manufacture - g. Month of manufacture - h. Batch number - i. Individual identifier - j. Standards - k. Read the Instructions for Use carefully - l. Model identification - m. Manufacturer address - o. Orientation of use - p. Nominal load - q. EN 1891 type A rope for EN 12841