

# ASAP

CE 0082

EN 353-2: 2002

EN 12841: 2006 A

EAC

TPTC019/2011 Patented

Mobile fall arrester for rope  
Antichute mobile sur corde

## WARNING / ATTENTION

Activities involving the use of this equipment are inherently dangerous. You are responsible for your own actions and decisions.

Before using this equipment, you must:

- Read and understand all Instructions for Use.
- Get specific training in its proper use.
- Become acquainted with its capabilities and limitations.
- Understand and accept the risks involved.



**FAILURE TO HEED ANY OF THESE WARNINGS MAY RESULT IN SEVERE INJURY OR DEATH.**

Les activités impliquant l'utilisation de cet équipement sont par nature dangereuses. Vous êtes responsable de vos actes, de vos décisions et de votre sécurité.

Avant d'utiliser cet équipement, vous devez :

- Lire et comprendre toutes les Instructions d'utilisation.
- Vous former spécifiquement à l'utilisation de cet équipement.
- Vous familiariser avec votre équipement, apprendre à connaître ses performances et ses limites.
- Comprendre et accepter les risques induits.



**LE NON-RESPECT D'UN SEUL DE CES AVERTISSEMENTS PEUT ÊTRE LA CAUSE DE BLESSURES GRAVES OU MORTELLES.**

## Traceability and markings Traçabilité et marquage

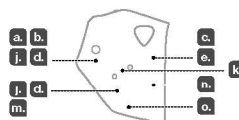

**a.** CE **b.** 0082

**APAVE SUDEUROPE SAS**  
8 rue Jean-Jacques Vernazza  
Z.A.C. Saunassy-Sèze - CS 60193  
13322 Marseille CEDEX 16 France  
N°0082

**e.** Individual number / Numéro individuel  
YY M 0000000 000

**f.** **g.** **h.** **i.**

**n.** Manufacturer address

**o.** Certification organisation (ANSI ASSE)

PETZL.COM



Latest version  
Dernière version



Other languages  
Autres langues



Technical tips  
Conseils techniques



PPE checking  
Fiche de contrôle EPI

Warning symbols  
Panneaux d'alertes



PETZL  
FR-39920 Crolles  
Cidex 105A  
PETZL.COM  
ISO 9001  
© Petzl



Sustaining our Community  
Au service de la Communauté  
FONDATION-PETZL.ORG

## 1. Field of application Champ d'application

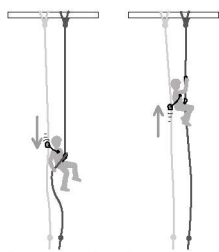

EN 12841 type A

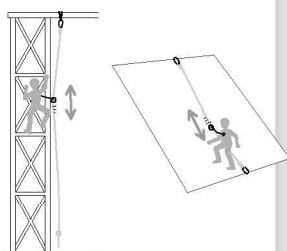

EN 353-2

## 4. Compatibility Compatibilité

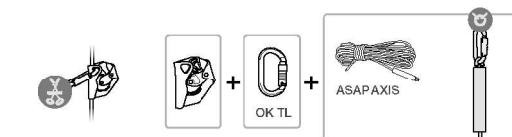
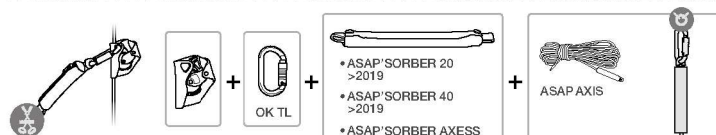
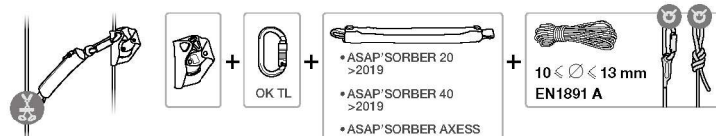

## 2. Nomenclature

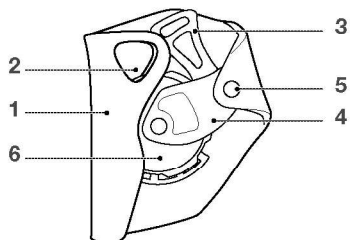

## 5. Working principle Principe fonctionnement

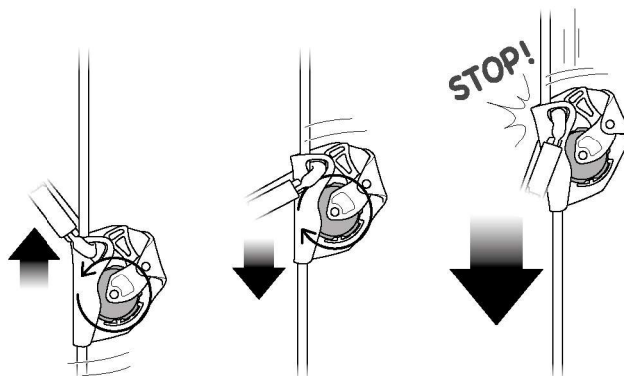

## 3. Inspection, points to verify Contrôle, points à vérifier



## 6. Installation and function test Mise en place et test de fonctionnement

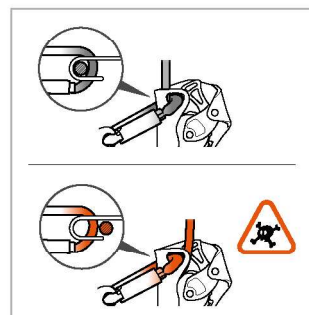
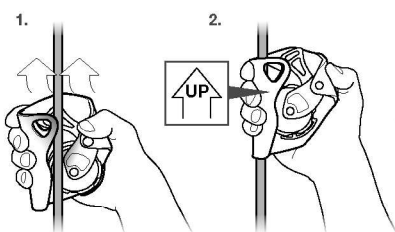

### Test

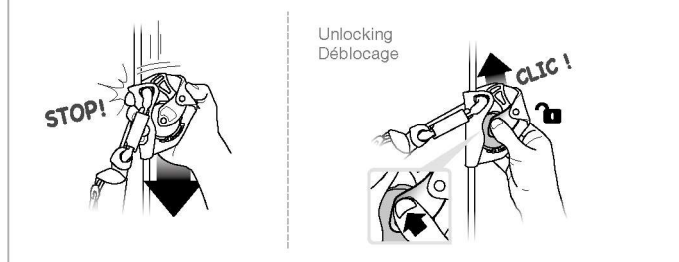

7. Precautions for use  
Précautions d'utilisation

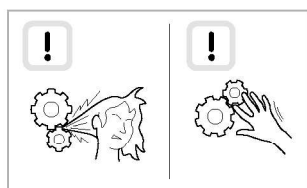
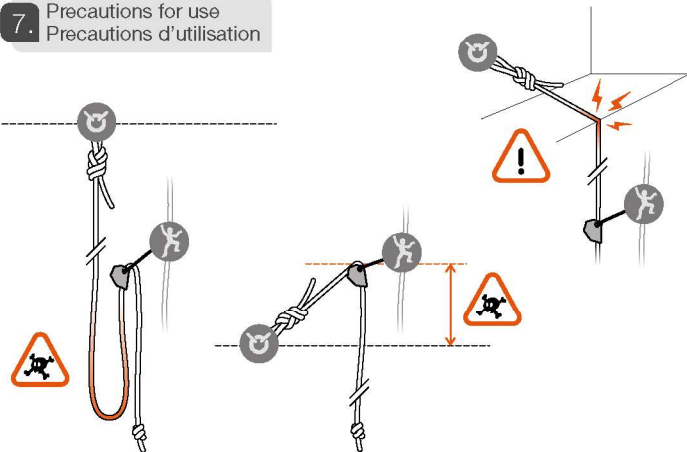

ASAP AXIS

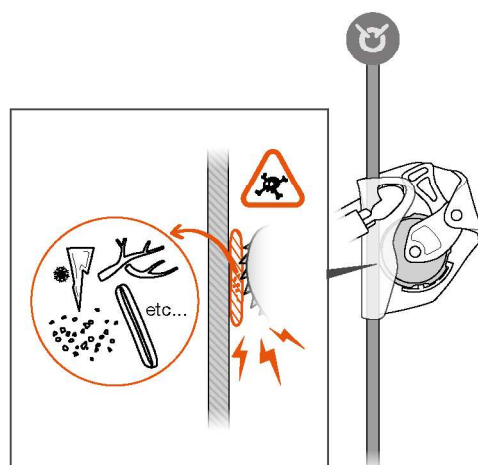
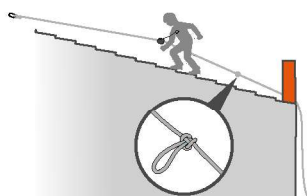
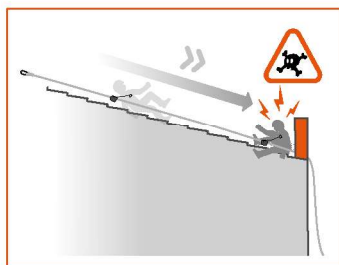
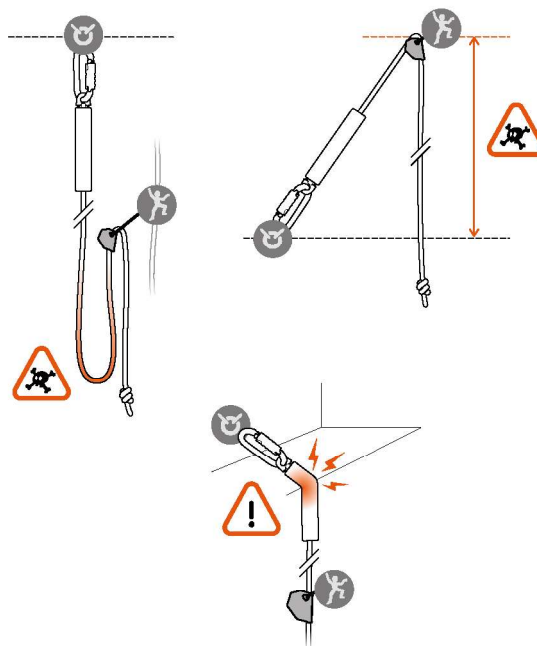

## 8. Clearance Tirant d'air

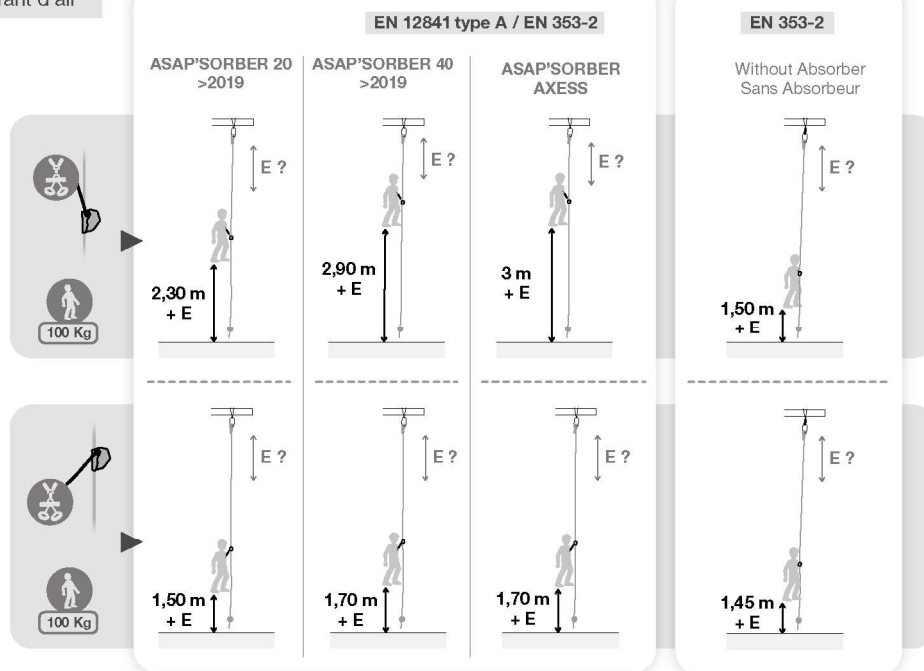

## 9. Cleaning (text part) Nettoyage (partie texte)

### 10. Additional information Informations complémentaires

<b>A. Lifetime / Durée de vie</b> unlimited / illimitée	<b>B. Acceptable T° / T° tolérées</b> + 50°C / + 122°F - 20°C / - 4°F
<b>C. Precautions for use / Précautions d'usage</b> etc...	
<b>D. Cleaning / Nettoyage</b>  + 30°C maxi. + 86°F maxi.	<b>E. Drying / Séchage</b>  + 30°C maxi. + 86°F maxi.
<b>F. Storage - Transport / Stockage - transport</b>  + 30°C / + 86°F + 10°C / + 50°F	<b>G. Maintenance Entretien</b> 
<b>H. Modifications - Repairs Modifications - Réparations</b>  → Petzl	<b>I. FAQ - Contact Questions - Contact</b>  → petzl.com



These instructions explain how to correctly use your equipment. Only certain techniques and uses are described. The warning symbols inform you of some potential dangers related to the use of your equipment, but it is impossible to describe them all. Check Petzl.com for updates and additional information. You are responsible for heeding each warning and using your equipment correctly. Any misuse of this equipment will create additional dangers. Contact Petzl if you have any doubts or difficulty understanding these instructions.

## 1. Field of application

Personal protective equipment (PPE) used for fall protection.

**ASAP: mobile fall arrester.**

**EN 12841 type A:** rope adjustment device for the safety rope. Backup device for a rope access system, to be used in conjunction with a type B or C progression device.

**EN 353-2:** mobile fall arrester including a flexible safety line. Primary belay device in a fall arrest system.

This product must not be pushed beyond its limits, nor be used for any purpose other than that for which it is designed.

## Responsibility

### WARNING

**Activities involving the use of this equipment are inherently dangerous. You are responsible for your own actions, decisions and safety.**

Before using this equipment, you must:

- Read and understand all Instructions for Use.
- Get specific training in its proper use.
- Become acquainted with its capabilities and limitations.
- Understand and accept the risks involved.

**Failure to heed any of these warnings may result in severe injury or death.**

This product must only be used by competent and responsible persons, or those placed under the direct and visual control of a competent and responsible person. You are responsible for your actions, your decisions and your safety and you assume the consequences of same. If you are not able, or not in a position to assume this responsibility, or if you do not fully understand the Instructions for Use, do not use this equipment.

## 2. Nomenclature

(1) Frame, (2) Attachment holes, (3) Safety catch, (4) Arm, (5) Arm axle, (6) Locking wheel.

Principal materials: aluminum alloy (frame, arm), stainless steel (locking wheel, safety catch), polyester, nylon (ropes).

## 3. Inspection, points to verify

Your safety depends upon the integrity of your equipment.

Petzl recommends a detailed inspection by a competent person at least once every 12 months (depending on current regulations in your country, and your conditions of usage). Warning: your intensity of use may cause you to inspect your PPE more frequently. Follow the procedures described at Petzl.com. Record the results on your PPE inspection form: type, model, manufacturer contact info, serial number or individual number, dates: manufacture, purchase, first use, next periodic inspection; problems, comments, inspector's name and signature.

### Before each use

**ASAP:** verify the absence of any cracks, marks, deformation, wear, or corrosion on the frame, arm, attachment holes and safety catch.

Verify that the arm and safety catch rotate on the axle, and that the return spring works properly. Verify that the locking wheel is clean and that the teeth are not worn out. Warning: if one or more teeth are missing, do not use the ASAP.

If the teeth are dirty, see the paragraph on Cleaning, maintenance. Verify that the locking wheel rotates smoothly, through one complete revolution in both directions.

**Rope:** check the condition of the rope according to the manufacturer's instructions. The rope must be retired if it has held a fall, if the core seems deformed, or if the sheath is damaged or stained.

### During use

It is important to regularly monitor the condition of the product and its connections to the other equipment in the system. Make sure that all items of equipment are correctly positioned with respect to each other.

Beware of foreign objects that can prevent the locking wheel from pressing against the rope, or from turning. Protect your ASAP from splashes while working.

## 4. Compatibility

Verify that this product is compatible with the other elements of the system in your application (compatible = good functional interaction).

Equipment used with your ASAP must meet current standards in your country (e.g. EN 361 harnesses in Europe...).

### Connector:

Use the ASAP only with the OK TRIACT-LOCK connector.

### Harness:

Connect the ASAP to the fall arrest attachment point on your harness.

### Energy absorber:

To extend the link between the ASAP and the harness, use only compatible Petzl energy absorbers:

- ASAP<sup>®</sup>SORBER 20 and 40.
- ASAP<sup>®</sup>SORBER AXESS.

The energy absorber must not be extended (one connector maximum (12 cm maximum length) at each end).

### Rope, EN 12841 type A usage:

Use the ASAP with 10-13 mm EN 1891 type A low stretch kernmantel ropes. Ropes tested during the EU EN 12841 type A certification:

- Petzl CLUB 10 mm.
- Teufelberger KM111 13 mm.

### Rope, EN 353-2 usage:

Use the ASAP only with the rope tested during the CE EN 353-2: 2002 certification: - Petzl ASAP<sup>®</sup>AXIS 11 mm.

## 5. Working principle

At moderate speeds, the locking wheel turns freely in both directions. When a rapid downward movement occurs, the locking wheel stops rotating and the rope is locked by being pinched between the wheel and the frame.

## 6. ASAP setup and function test

Warning: the ASAP is a directional device and locks in only one direction. Danger of death if the ASAP is positioned upside down on the rope.

### Perform a function test for each installation.

**Unlocking:** after the function test, unlock the wheel to enable normal movement on the rope.

## 7. Precautions for use

Possible to create a travel-stop by tying a knot in the rope.

As you progress, regularly check that the rope is moving properly through the ASAP, to avoid creating a loop of slack that could increase the potential fall distance.

A dynamic overload can damage the rope. If the ASAP's rope is loaded, the user must be equipped with another backup system.

### ASAP<sup>®</sup>AXIS:

Use the termination, manufactured with an integrated energy absorber, connected to the anchor.

In case of a fall or sudden loading of the system, verify that the energy absorber is intact, and has not been activated.

### Usage on an incline:

WARNING: in case of a slow slide on a low-angle roof, for example, the ASAP may not activate immediately. Be sure to tie a stopper knot in the rope if there is a risk of hitting an obstacle.

## 8. Clearance

Clearance is the minimum amount of clear space below the user that prevents the user from hitting an obstacle in the event of a fall.

Clearance takes into account:

- The length of the fall.
- The ASAP's stopping distance.
- The tearing length of the energy absorber.
- The average height of the user.
- A safety margin of 1 m.
- The rope's elasticity (E) varies according to the situation and must be added to your clearance calculation.

For more information, see the ASAP technical tips at Petzl.com.

The values presented are based on theoretical estimations and fall tests using a rigid mass.

In a fall arrest system, take into account the length of any connectors that will have an effect on the fall distance.

## 9. Cleaning, maintenance

Avoid getting any liquid inside the locking wheel's mechanism.

To clean the locking wheel teeth, using a solvent is not recommended, but is possible if applied with a brush, taking care to avoid getting any solvent in the mechanism.

## 10. Additional information

This product meets the requirements of Regulation (EU) 2016/425 on personal protective equipment. The EU declaration of conformity is available at Petzl.com.

- You must have a rescue plan and the means to rapidly implement it in case of difficulties encountered while using this equipment.

- The anchor point for the system should preferably be located above the user's position and should meet the requirements of the EN 795 standard (12 kN minimum strength).

- In a fall arrest system, it is essential to check the required clearance below the user before each use, in order to avoid hitting the ground or an obstacle in case of a fall.

- Make sure that the anchor point is correctly positioned, in order to limit the risk and the length of a fall.

- A fall arrest harness is the only device allowable for supporting the body in a fall arrest system.

- When using multiple items of equipment, a dangerous situation can arise in which the safety function of an item of equipment can be affected by the safety function of another item of equipment.

- WARNING - DANGER: ensure that your products do not rub against abrasive or sharp surfaces.

- Users must be medically fit for activities at height. WARNING: inert suspension in a harness can result in serious injury or death.

- The Instructions for Use for each item of equipment used in conjunction with this product must be followed.

- The Instructions for Use must be provided to the user of this equipment, in the language of the country where the equipment is used.

- Make sure the markings on the product are legible.

### When to retire your equipment:

WARNING: an exceptional event can lead you to retire a product after only one use, depending on the type and intensity of usage and the environment of usage (harsh environments, marine environments, sharp edges, extreme temperatures, chemicals...).

A product must be retired when:

- It has been subjected to a major fall or load.
- It fails to pass inspection. You have any doubt as to its reliability.
- You do not know its full usage history.
- When it becomes obsolete due to changes in legislation, standards, technique or incompatibility with other equipment...

Destroy these products to prevent further use.

### Icons:

**A. Unlimited lifetime - B. Acceptable temperatures - C. Usage precautions - D. Cleaning/disinfection - E. Drying - F. Storage/transport - G. Maintenance - H. Modifications/repairs** (prohibited outside of Petzl facilities, except replacement parts) - **I. Questions/contact**

### 3-year guarantee

Against any material or manufacturing defect. Exclusions: normal wear and tear, oxidation, modifications or alterations, incorrect storage, poor maintenance, negligence, uses for which this product is not designed.

### Warning symbols

1. Situation presenting an imminent risk of serious injury or death. 2. Exposure to a potential risk of accident or injury. 3. Important information on the functioning or performance of your product. 4. Equipment incompatibility.

### Traceability and markings

a. Meets PPE regulatory requirements. Notified body performing the EU type examination - b. Number of the notified body responsible for the production control of this PPE - c. Traceability: datamatrix - d. Rope compatibility - e. Serial number - f. Year of manufacture - g. Month of manufacture - h. Batch number - i. Individual identifier - j. Standards - k. Read the Instructions for Use carefully - l. Model identification - m. Nominal maximum load - n. Manufacturer address - o. ANSI/VASSE certification body